



Parcel 2



- SWC US Highway 1 at 53rd Street
- Signalized Intersection
- Strong Residential Growth
- Excellent access & visibility
- Outparcel Opportunity
- Adjacent to Publix

Demographics

	3 Miles	5 Miles
2011 Population	33,574	79,314
2011 Avg. Household Income	\$61,645	\$53,827
2011 Est. Households	13,847	34,795

Michael Collard Properties
 "ATTENTION TO RETAIL"

Developed by Michael Collard Properties
 4798 New Broad Street, Suite 220
 Orlando, FL 32814
 PH: 407-599-4444



Parcel 3

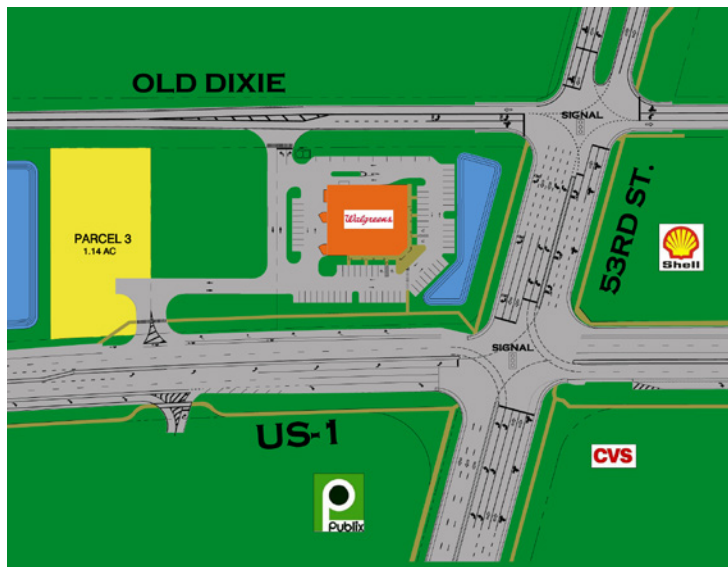

SWC US Highway 1 at 53rd Street
 Signalized Intersection
 Strong Residential Growth
 Excellent access & visibility
 Outparcel Opportunity
 Adjacent to Publix

Demographics

	3 Miles	5 Miles
2011 Population	33,574	79,314
2011 Avg. Household Income	\$61,645	\$53,827
2011 Est. Households	13,847	34,795

Michael Collard Properties
 "ATTENTION TO RETAIL"

Developed by Michael Collard Properties
 4798 New Broad Street, Suite 220
 Orlando, FL 32814
 PH: 407-599-4444